

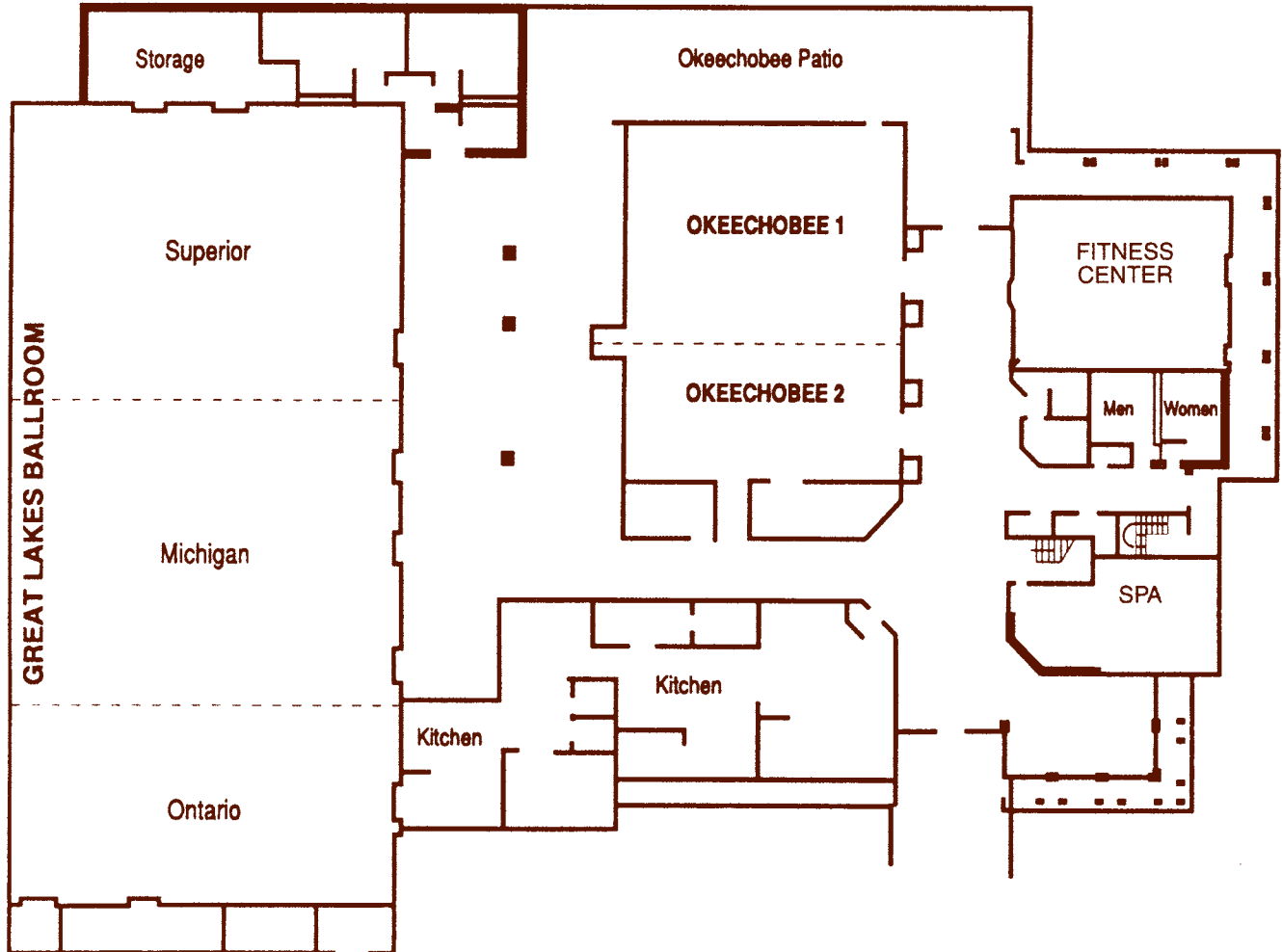

# DOUBLETREE BY HILTON ORLANDO AT SEAWORLD LAKES CONFERENCE CENTER



## LAKES CONFERENCE CENTER

Room	Dimensions	Square Feet	Conference	Classroom	Theater	Hollow Sq	U-Shape	Reception	Rounds 10	Rounds 8
GREAT LAKES	68'x114'x20'	9,792	N/A	600	1200	N/A	N/A	1,000	800	640
SUPERIOR	68'x48'x20'	3,264	54	198	400	84	66	250	270	200
MICHIGAN	68'x48'x20'	3,264	54	180	400	78	60	250	250	200
ONTARIO	68'x48'x20'	3,264	54	198	400	84	66	250	250	200
OKEECHOBEE	50'x64'x10'	3,200	48	200	400	78	66	250	250	200
OKEECHOBEE 1	50'x33'x10'	1,650	36	96	200	48	45	100	120	96
OKEECHOBEE 2	50'x31'x10'	1,550	36	96	200	48	45	100	120	96
OKEECHOBEE P ATIO			N/A	N/A	N/A	N/A	N/A	120	120	96